

Included Components

1. AM/FM CD/Card Reader x1
2. AM Antenna Set x1
3. FM Antenna Wire x1
4. Dual RCA Cable x1
5. AC Power Cord x1
6. Remote Control x1
7. Quick Start Guide x1



What May be Needed to Rack (Not Included)

1. Rack Screws 10/32 x .75", Phillips Truss Head Screws
2. #2 Phillips Head Screwdriver

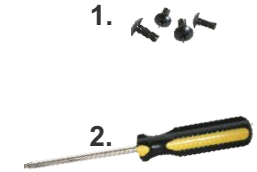

Setup



1 Connect Power Cable to the RM-CDU. Connect the other end to a power outlet. (Optional DC 13.2 Power Cable may also be used)

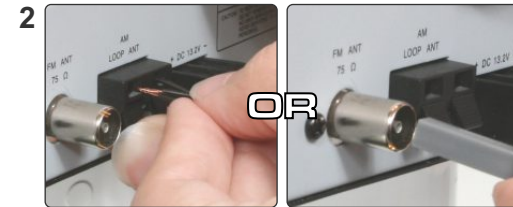

2 Attach the AM and/or FM Antenna on the RM-CDU.



3 Make sure the volume is reduced on the Amplifier, Mixer, or Receiver that will be used until ready for sound. Connect RCA Cable to the Left and Right RCA Outputs. Connect to Amplifier, Mixer, or Receiver.

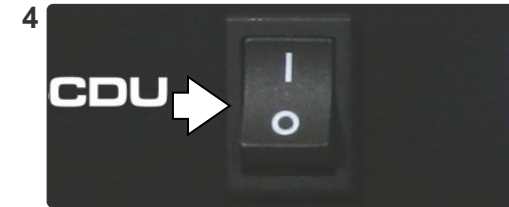

4 Power on the RM-CDU.

Racking/Mounting (Optional)



1 Align RM-CDU up evenly. Turn the screw but leave room to adjust. Once all four screws are in place, tighten securely.

Radio Operation

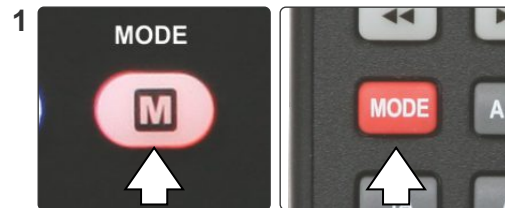

1 To use the AM/FM Radio, Press MODE for radio mode.

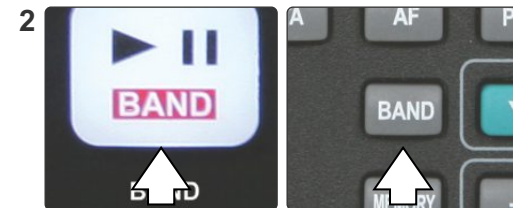

2 To Select FM 1, FM 2 or AM frequencies, Press "BAND".



3 Press "TUNING ▲" or "TUNING ▼" to select channel. If using the remote, Press "▲" or "▼" to select channel.



4 To start auto scan search, hold TUNING for over 3 seconds. If using the remote, press the "-" or "+" to auto scan. Scanning stops when unit receives the station.



5 To set a memory CH, press "MEM" then press "M ▲", then MEM again. To play the stored station, press "M ▲" button under RADIO mode. To play a stored station on the remote, press M1 ~ M10. (10 memory assignable per freq. band)

CD/Card Operation

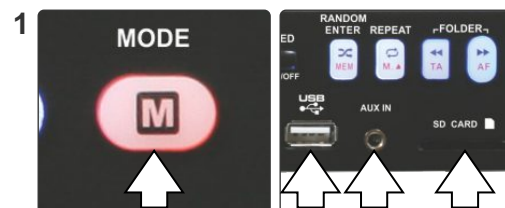

1 To use the CD Player, USB, SD, or AUX: Insert the media of choice, then press MODE for media player mode. Note: AUX overrides all other media functions.



2 To play from the beginning, Press the Play button. To play a specific track, press the "Prev" or "Next" to get to the track you want to play. Alternatively, you can press the fast forward or rewind buttons to forward and rewind. Press again to stop the fast forwarding or rewinding. ("F.B", "F.F", "REV." and "F.WD" buttons)



3 Press Repeat once to repeat current track, display will show "REP 1". Press twice for the entire CD, display will show "ALL". Press again to cancel repeat. For an MP3 formatted CD, USD, or SD card, press Repeat once to repeat current track, twice for the entire folder (will show "REP1 F") a third time for all songs, and again to cancel.



4a Up to 10 songs can be stored to memory. Select desired song and press "PROG", LCD will show "PROG", then press ENTER to store selected song. The display will show "00 01" for the first song. Repeat the process for more songs up to 10.



4b Press Play/Pause to play the programmed songs. The LCD will show "MEMO". Press forward and backward buttons to select between programmed songs. Press "PROG" again to cancel program function.



FAQ

1. **Q. I'm not sure what I'm listening to. How can I see the Program Type?**
A. Press "PTY" to see if your station has a program type assigned to their show. If not, the LCD will display "NO PTY".

2. **Q. How can I see what program service I'm listening to because I only see the station?**
A. Press "DISP" to switch from Classic, to the Program Service. If a Program Service is not available, it will show "NO PS".

3. **Q. My radio reception is not very good, how can I improve it?**
A. Make certain the Antennas are located outside of the rack. If needed, an external Antenna may be required in your location. These are readily available from many retailers.

4. **Q. When I press the Mode button, it only shows the radio.**
A. It will only switch to CD or SD when a CD or SD Card is inserted. After inserting your CD or SD Card, press the Mode button to access them.

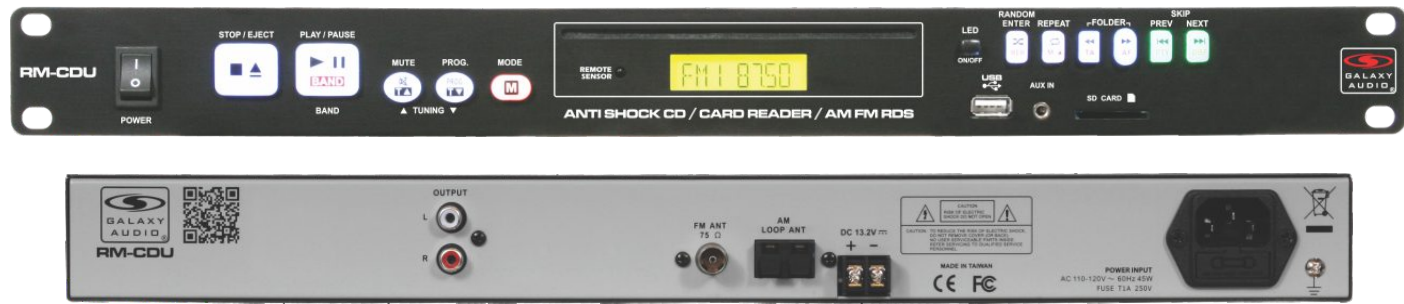

MAKERS OF THE ORIGINAL
HOT SPOT PERSONAL MONITOR

BE HEARD™

Other Helpful Sources

RM-CDU
Product Page



RM-CDU
Manual



(PDF Download)

RM-CDU
Cutsheet



(PDF Download)

RM-CDU
How To Video



Specifications subject to change without notice.

601 E. Pawnee Wichita, KS 67211 316. 263.2852 FAX 316.263.0642 www.galaxyaudio.com
 Distributed in Canada by Audio Distributors International (ADI) 1275 Newton, unit 6 Boucherville, QC J4B 5H2 Canada
 450.449.8177 FAX 450.449.8180
 Distributed outside the United States by TradeLink America, LLC. 230 Kings Mall Ct., Suite 182 Kingston, NY 12401
 MikeH@TradeLinkAmerica.com TEL 1.845.246.6200 FAX 1.845.746.9070