

# RM-CD



## Instruction Guide

# **ANY SPOT<sup>®</sup>** **TRAVELER<sup>®</sup>** OPTIONAL MODULE

*Anti Shock CD / USB / SD Card Reader / Remote Control Player*



<http://galaxyaudio.com/products/rm-cd>



MAKERS OF THE ORIGINAL  
HOT SPOT PERSONAL MONITOR

## Description of Controls



1. USB Connector: Used to play MP3 files from an external source.
2. POWER:
  - ON: Press Power button to switch on the power.
  - OFF: Press and hold to switch off the power.
3. CD Slot: Carefully insert a CD here.
4. LCD Display: Displays track, time played, mode selected
5. PLAY / PAUSE: Press once to play, press again to pause.
6. SD Card Slot: Accepts SD and SDHC Cards containing MP3 files.
7. Infrared Window: Picks up the signal from the remote control.
8. STOP/ EJECT: Press once to stop play. Press again to eject disc.
  - a. When stopped the LCD will display all track numbers.
  - b. When pressed again the LCD shows "EJECT". Press again to re-insert the disk.
9. MODE - SD/USB/CD: Press this key to select USB, SD, or CD mode.
10. RAN / ENTER: Shuffle and execute button. Press once to activate shuffle feature. The LCD display will show "SHUFFLE" and start to play from available tracks. When in the programming mode, this button will execute the ENTER command.
11. REP / ID3: Press to repeat tracks. There are three modes to select between.
  - a. Press once to repeat a single WAV track from CD. The LCD will show REPEAT 1. Press twice to repeat all tracks. The LCD will show REPEAT ALL. Press 3 times to cancel the repeat function. "Repeat" will be removed from the LCD.
  - b. Press once to repeat a single MP3 track from CD, USB or SD Card. The LCD will show REPEAT 1. Press twice to repeat all tracks in the folder. The LCD will show REPEAT FOLDER. Press 3 times to repeat all tracks in all folders. The LCD will show REPEAT ALL. Press 4 times to cancel the repeat function. "Repeat" will be removed from the LCD.

**Note:** that enabling the Shuffle/Random will remove the repeat setting. And vice versa, selecting a Repeat mode will remove the Shuffle/Random mode.
12. FOLDER ◀◀: Press to select previous folder.
13. FOLDER ▶▶: Press to select next folder.
14. REV: Press and release to select previous track number. Press and hold for fast reverse.
15. F.WD: Press and release to select next track number. Press and hold for fast forward.
16. MUTE: Press to mute audio.
17. PROG: Press to program the order of track play.
  - a. To program WAV files from CD media: Press once till the LCD display shows "PROGRAM", then use the SKIP previous or next buttons to select the first track. Then press the ENTER button. Repeat SKIP and ENTER commands to program additional tracks. When finished, press PLAY. The LCD will show "MEMORY" and start to play the programmed tracks.
  - b. To program MP3 files from CD, USB, or SD media: Press once till the LCD display shows "PROGRAM" then press FOLDER ▶▶ to select the desired folder, then use the SKIP previous or next buttons to select the first track. Then ◀◀ press the ENTER button. Repeat SKIP and ENTER commands to program additional tracks. When finished, press PLAY. The LCD will show "MEMORY" and start to play the programmed tracks.
  - c. Press **PROG** to cancel the programming function.
18. VOLUME: Rotate to adjust & control the desired volume.

## LCD Display:

- When in MP3 mode, the display shows **MP3**.
- When in CD (WAV) mode, the display shows **CD**.
- When in Play mode, the display shows ►. When paused, the display shows ||.
- When repeatedly playing a single track, it shows **REPEAT 1**.
- When it shows **REPEAT FOLDER**, it refers to playing the tracks repeatedly from a specific folder.
- When all songs in all folders are playing repeatedly, it shows **REPEAT ALL**.
- **SHUFFLE**: When random playback is active.
- **PROGRAM**: When programming tracks.
- **MEMORY**: When playback memory is active.
  - : Under the MP3 mode, it will show the folder numbers.
  - : Displays the current playing track.
  - :□□: Displays the time for the current playing track.

## Memory:

When playing, if the unit is switched off and then back on, or switched to another mode and then back to the former playing mode, the RM-CD will play automatically from the previous status.

## Playing:

- This player accepts 12 cm discs including CD, CD-R, CD-RW, MP3 disks, as well as USB and SD / SDHC Cards with MP3 files. This unit does not play 8 cm discs or computer CDs.
- This player accepts format MP3 and WMA formats.

## Note:

- *When inserting or removing a disc from the CD slot, please allow the RM-CD to insert and return the disc automatically. Damage may result from pushing in or pulling out the disk by hand.*

## USB:

- Insert a USB device or cable into the USB connector in the faceplate. Press the CD / USB / SD button on the remote control or faceplate repeatedly until "USB" is displayed. The media will play automatically.

## SD / SDHC Card:

- Insert an SD or SDHC Card into the SD slot in the faceplate, and push the card in fully to lock it in place. To remove the card, push the card in again to release it, and gently pull out the card. Do not use excessive force to remove the card, or damage may result.

For other operations please see: **PLAYING** and **THE FUNCTIONS RESPECTIVELY ON THE REMOTE CONTROL**.

## Functions of the Remote Control

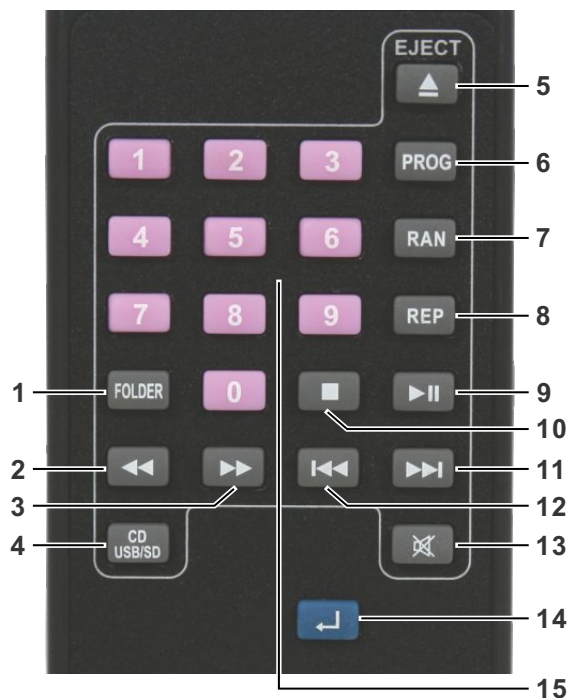

1. **FOLDER** : Press this key to select folder during MP3 playing.
2. **⏮** : Press once to activate fast reverse. Press again to cancel fast reverse. Then press **▶**, to resume normal play.
3. **⏭** : Press once to activate fast forward. Press again to cancel fast forward. Then press **▶**, to resume normal play.
4. **CD USB/SD** : Press to select USB, SD, or CD mode.
5. **EJECT ▲** : Press to eject a disc from the CD slot.
6. **PROG** : Press to program the order of track playback as follows:
  - a. For WAV media files from a CD: Press once and the LCD display will show “PROGRAM”. Then use the 0~9 number buttons or **⏮** and **⏭** to select the track. Press **◀** to enter selection. Repeat to select and enter additional tracks. Once finished, press **▶**. The LCD DISPLAY will show “MEMORY” and then start to play.
  - b. For MP3 files on CD, USB, or SD Cards: Press once and the LCD display will show “PROGRAM”. Then use **⏮** and **⏭** to select the folder and use **⏮** and **⏭** to select the track. Press **◀** to enter selection. Repeat to select and enter additional tracks. Once finished, press **▶**. The LCD DISPLAY will show “MEMORY” and then start to play. To cancel this function, press **PROG** again.
7. **RAN** : A random order of available tracks is played. Press **RAN** and the LCD will show SHUFFLE, and start to play.
8. **REP** : Repeat play function.
  - a. Press once to repeat a single WAV track from CD. The LCD will show REPEAT 1. Press twice to repeat all tracks. The LCD will show REPEAT ALL. Press 3 times to cancel the repeat function. “Repeat” will be removed from the LCD.
  - b. Press once to repeat a single MP3 track from CD, USB or SD Card. The LCD will show REPEAT 1. Press twice to repeat all tracks in the folder. The LCD will show REPEAT FOLDER. Press 3 times to repeat all tracks in all folders. The LCD will show REPEAT ALL. Press 4 times to cancel the repeat function. “Repeat” will be removed from the LCD.
9. **▶** : PLAY / PAUSE. Press once to play ▶. Press again to pause **⏸**.
10. **■** : STOP: Press to stop play.
11. **⏭** : Skip to the next track.
12. **⏮** : Skip to the previous track.
13. **🔇** : ON / OFF Audio Mute.
14. **↵** : Enter Command.
15. Number Keys 0~9: Press to select track numbers

# Remote Battery Installation

When using the remote control, point the remote to the faceplate of the RM-CD. The optimal transmitting distance is 3 meters. The remote control battery is model CR2025, 3V.

## Battery Installation:

1. Press and hold the tenon located on the lower left-hand corner of the rear of remote control. Pull out the battery holder.
2. Install the battery according to its correct polarity (positive electrode faces upwards).
3. Push the battery holder back into the remote until it locks in position.

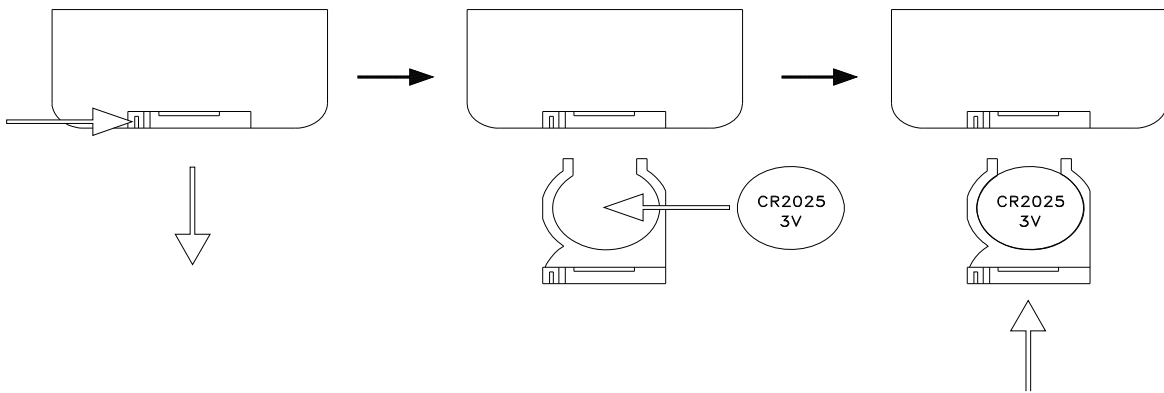



MAKERS OF THE ORIGINAL  
HOT SPOT PERSONAL MONITOR



[www.galaxyaudio.com](http://www.galaxyaudio.com)

# **RM-CD**

## **Instruction Guide**

Specifications in this guide are subject to change without notice.  
For the most up to date guide and information  
visit [www.galaxyaudio.com](http://www.galaxyaudio.com).

1-800-369-7768    [www.galaxyaudio.com](http://www.galaxyaudio.com)

© Copyright Galaxy Audio 2017

V20170426