

Included Components

1. MSPA5 x1
2. YBSAMS5 x1
 - a. Yoke Bracket x1
 - b. Wing Screws x3
 - c. Bracket Rubber Washers x2
 - d. Rubber Feet x4
 - e. Washer x1
 - f. SA-1
3. IEC Power Cable x1
4. Quick Start Guide x1

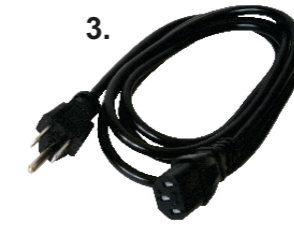

Setup

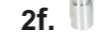
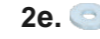

1 Connect power cable to MSPA5, connect other end to a power outlet.

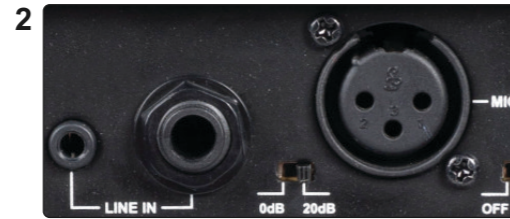

2 Choose the input needed:
XLR for microphone or line level.
1/4" for balanced/unbalanced line level.
1/8" for stereo from a media player etc.

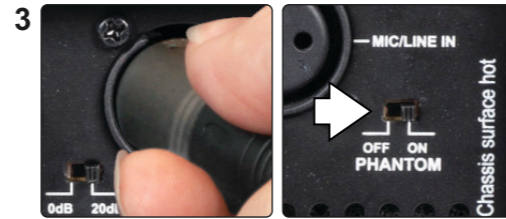

3 For a microphone, plug the XLR male end of the cable into the XLR female connector on the MSPA5. If the microphone is a condenser that requires phantom, turn on phantom power switch.

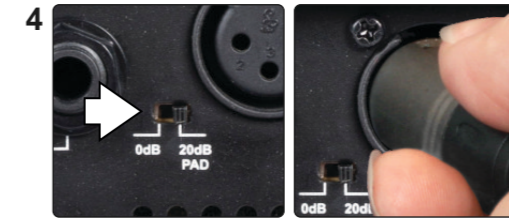

4 For line level with an XLR cable, move the 0,20dB switch to the 20dB PAD position. Plug the XLR male end of the cable into the XLR female connector on the MSPA5.



5 For line level with a 1/4" cable, plug into the 1/4" input that is to the left of the XLR. This can be a balanced TRS or an unbalanced TS input.



6 For a stereo signal from an MP3 player, attach 1/8" stereo cable into the 1/8" input, this input will sum left and right.

Stand Mounting (Optional)



1 Attach the bracket to the MSPA5 using 2 wing screws and 2 rubber washers.



2 Attach the SA-1 to the mic stand.
Attach the MSPA5 and bracket to the SA-1 using 1 washer and 1 wing screw.

Wall Mounting (Optional)



3 Insure you have a solid surface to mount to, secure the bracket to the wall using proper mounting hardware for the surface. Attach the MSPA5 to the bracket as shown in step 1 of "Stand Mounting"

NOTE: Proper local building codes and standards must be followed when installing your Micro Spot Speaker on any surface. For any installation in which the Micro Spot Speaker is mounted on a ceiling or wall, please consult with a licensed contractor or professional engineer. Galaxy Audio will not be held responsible for damages caused by improper installations of any bracket or speaker.

*Wall mounting hardware is not included.

Operation



1 Insure the input level control is turned down (fully counter-clockwise) Turn the power switch on.



2 Level control: turn clockwise to raise the level. Turn counter-clockwise to lower the level.

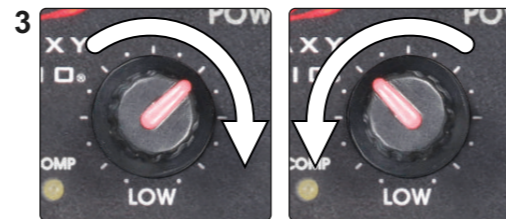

3 Tone controls: To increase the low frequencies, turn the "Low" tone control clockwise. To decrease, turn counter-clockwise.

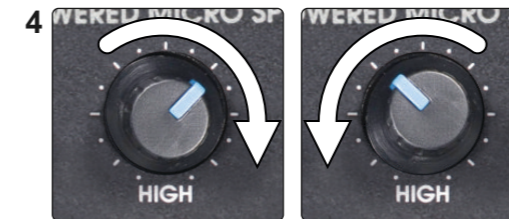

4 Tone controls: To increase the high frequencies, turn the "high" tone control clockwise. To decrease, turn counter-clockwise.



5 Max. level is reached when the yellow "Comp" light only flashes at peak levels. If the light is on constantly, turn the level control down to avoid damage to the MSPA5.



Quick Start Guide

FAQ



- 1. Q. My condenser mic does not work.**
A. Make sure the Phantom Power switch is on.

- 2. Q. I'm using the XLR input, but it is distorted and I can barely turn it up before it is too loud.**
A. Engage the 20dB PAD.

- 3. Q. Will I get left and right when plugging my MP3 player into the 1/8" jack?**
A. Yes. It sums the two together.



MAKERS OF THE ORIGINAL
HOT SPOT PERSONAL MONITOR

BE HEARD™

Other Helpful Sources

MSPA5
Product Page



MSPA5
Manual



(PDF Download)

MSPA5
Cutsheet



(PDF Download)

YouTube
How To Video



Specifications subject to change without notice.